

1 2 3 4 5 6

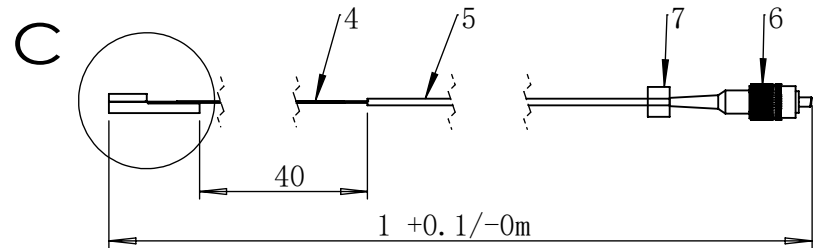
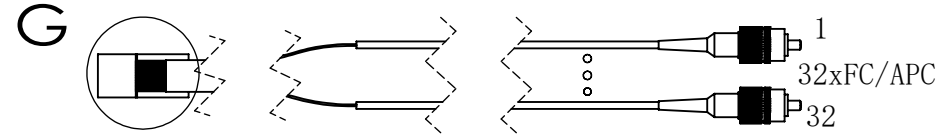
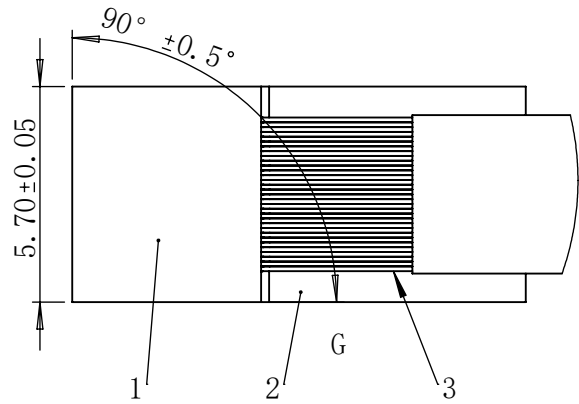
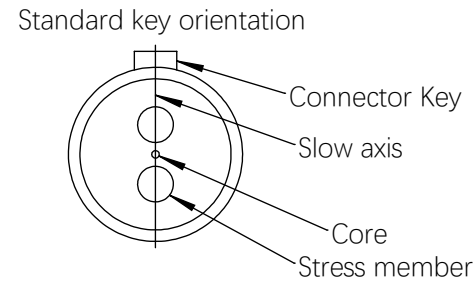
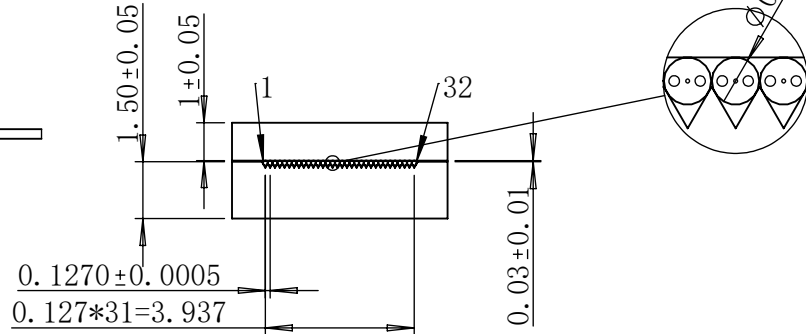
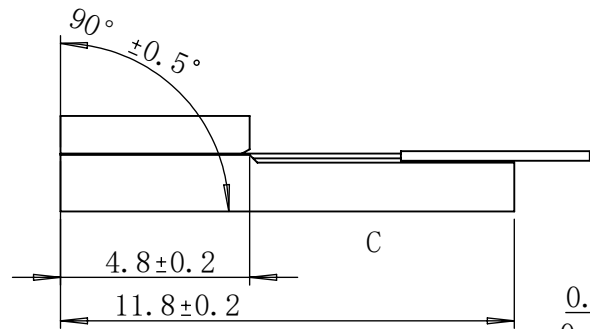

ITEM	PART	MATERIAL	DESCRIPTION	QTY
1	Array lid	Glass	5.7x5x1	1
2	Array base	Glass	32V-127P-5.7x12x5x1.5t	1
3	Cladding fiber	Glass	/	32
4	Bare fiber	Glass+Acrylate	Corning PM15-U25D fiber	32
5	Fiber jacket	Hytrel	0.9mm blue loose tube	32
6	Fiber Connector	Nickel plated brass	FC/APC	32
7	Wear cable marker	Polyethylene	Number : 1-32	32
8	IL≤0.3dB , PER≥18dB			

DIMENSIONS ARE IN MM		NAME	DATE
X ± 0.15 .X ± 0.10 .XX ± 0.05 ANGULAR ± 0.5°		D2	2024/1/4
ALL MACHINED SURFACE TO BE $3.2/\sqrt{\text{V}}$		Q.A.	Q1
BREAK SHARP CORNERS MAX		PROPRIETARY AND CONFIDENTIAL THE INFORMATION CONTAINED IN THIS DRAWING IS THE SOLE PROPERTY OF PHIX PHOTONICS ASSEMBLY. ANY REPRODUCTION IN PART OR AS A WHOLE WITHOUT THE WRITTEN PERMISSION OF PHIX PHOTONICS ASSEMBLY IS PROHIBITED.	

**phix** PHOTONICS ASSEMBLY

TITLE: GC-32ch PMFA-FC/APC

SIZE	PART NO. or DWG. NO.	REV
A4	30150391 151978	A

SCALE:1:2 SHEET 1 OF 1

REV.	DESCRIPTION	DATE	REVISED
A		2024/1/4	D2

1 2 3 4 5 6